

A. System Overview



One-Hole, Straight Fixed Tongue Lug

B1. Cable Ties

For Use with Stranded Copper Code Conductors

Type CX

- Made from high strength electrolytic copper to provide premium electrical and mechanical performance
- Compact design saves space
- Wide wire range-taking capability minimizes inventory requirements
- Inspection window to visually assure full conductor insertion
- Plated steel set screw provides high strength, durable electrical contact between conductor and connector
- UL Listed and CSA Certified for use up to 600 V

B2. Cable Accessories

B3. Stainless Steel Ties



C1. Wiring Duct

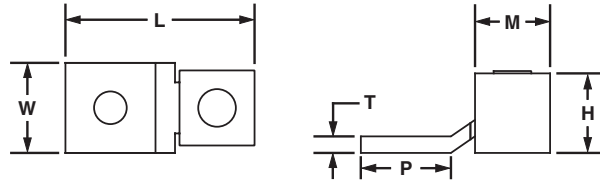

C2. Surface Raceway

C3. Abrasion Protection

| Part Number | Copper Conductor Size Range | Current Rating (Amps) | Stud Hole Size (In.) | Hex Size (In.) | Figure Dimensions (In.) | | | | | | Std. Pkg. Qty. |
|---------------------|--|-----------------------|----------------------|----------------|-------------------------|------|------|------|------|------|----------------|
| | | | | | L | W | H | T | P | M | |
| CX35-36-CY | #14 AWG – #6 AWG | 35 | 3/16 | ** | 1.02 | 0.38 | 0.48 | 0.07 | 0.44 | 0.38 | 100 |
| CX70-14-CY | #14 AWG – #4 AWG, (2) #14 AWG, (2) #12 AWG | 70 | 1/4 | ** | 1.27 | 0.50 | 0.57 | 0.08 | 0.59 | 0.50 | 100 |
| CX125-14-QY* | #4 AWG – 1/0 AWG | 125 | 1/4 | ** | 1.53 | 0.62 | 0.77 | 0.13 | 0.84 | 0.62 | 25 |
| CX225-56-QY* | #2 AWG – 4/0 AWG | 225 | 5/16 | 3/16 | 2.19 | 1.00 | 1.13 | 0.13 | 1.06 | 1.00 | 25 |

*cULus Listed for use up to 600V.
**Uses slotted head set screw.

C4. Cable Management

D1. Terminals



One-Hole, Straight Fixed Tongue, Tin-Plated Lug

D2. Power Connectors

For Use with Stranded Copper Code Conductors

Type CX-T

- Made from high strength electrolytic copper to provide premium electrical and mechanical performance
- Tin-plated to inhibit corrosion
- Compact design saves space
- Wide wire range-taking capability minimizes inventory requirements
- Inspection window to visually assure full conductor insertion
- Plated steel set screw provides high strength, durable electrical contact between conductor and connector
- UL Listed and CSA Certified for use up to 600 V

D3. Grounding Connectors

E1. Labeling Systems

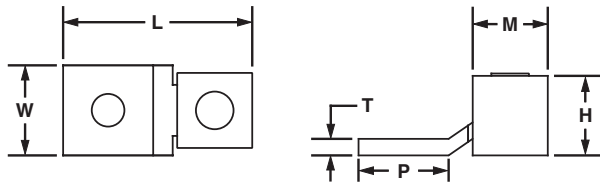

E2. Labels

E3. Pre-Printed & Write-On Markers

| Part Number | Copper Conductor Size Range | Current Rating (Amps) | Stud Hole Size (In.) | Hex Size (In.) | Figure Dimensions (In.) | | | | | | Std. Pkg. Qty. |
|----------------------|--|-----------------------|----------------------|----------------|-------------------------|------|------|------|------|------|----------------|
| | | | | | L | W | H | T | P | M | |
| CX35-36T-CY | #14 AWG – #6 AWG | 35 | 3/16 | ** | 1.02 | 0.38 | 0.48 | 0.07 | 0.44 | 0.38 | 100 |
| CX70-14T-CY | #14 AWG – #4 AWG, (2) #14 AWG, (2) #12 AWG | 70 | 1/4 | ** | 1.27 | 0.50 | 0.57 | 0.08 | 0.59 | 0.50 | 100 |
| CX125-56T-QY* | #4 AWG – 1/0 AWG | 125 | 5/16 | ** | 1.53 | 0.62 | 0.77 | 0.13 | 0.84 | 0.62 | 25 |
| CX225-38T-QY* | #2 AWG – 4/0 AWG | 225 | 3/8 | 3/16 | 2.19 | 1.00 | 1.13 | 0.13 | 1.06 | 1.00 | 25 |
| CX225-56T-QY* | #2 AWG – 4/0 AWG | 225 | 5/16 | 3/16 | 2.19 | 1.00 | 1.13 | 0.13 | 1.06 | 1.00 | 25 |

*cULus Listed for use up to 600V.
**Uses slotted head set screw.

E4. Permanent Identification

E5. Lockout/Tagout & Safety Solutions

F. Index